

Cleaning

In order to maintain printer performance, it is important that it is cleaned regularly.

Refer to printer user's manual for more information.

Maintenance

It is very important to maintain your Javelin card printer properly according to the instructions provided in the printer user's manual.

If you have any difficulty with your new Javelin card printer and have not been able to find a solution in the user's manual, please contact your dealer or visit our website: **www.nbstech.com**

How to return your printer

It is very important that all packing material is safely kept in case you need to move or re-ship the printer. Be sure the complete packing material is stored in a dust free environment.

Remove ribbon cartridge prior to packaging the printer for shipment and place it back in the dedicated area in the printer box.

Before returning the printer to your dealer or to NBS, please refer to the printer user's manual.

Thank you for choosing the JAVELIN® card printer!

J110i/m & J120i QS
February 2008



Javelin®

J110i/m & J120i
Card Printer

Quick Start!



Before starting to work with your new JAVELIN card printer, please refer to this Quick Start guide. For more complete information regarding all aspects of your printer's operation, please refer to the printer user's manual on the CD rom.



J A V E L I N

www.nbstech.com

980575 - 003

Setup

1. Unpack your JAVELIN® card printer

Make sure the following items are included:

- Power & USB cables
- Power transformer
- Ribbon cartridge
- Driver & documentation CD
- Cleaning kit
- Quick Start guide (this document)

If any items are missing, please contact your dealer.

2. Open lid

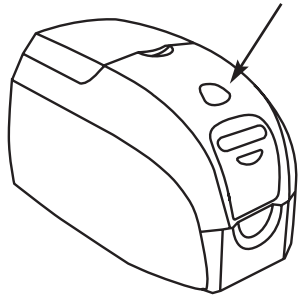

Open printer lid by pressing the cover release button on the top of your printer.

3. Loading ribbon cartridge

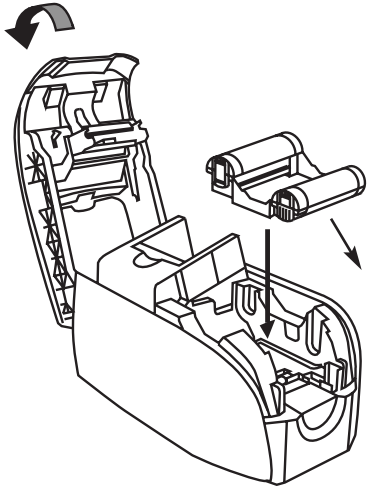

Peel protective wrapper from adhesive cleaning roller by gently pulling on the tape.

Insert the ribbon cartridge with the cleaning roller facing down, so the gears on the ends of the rollers fit into the appropriate slots.

Close the printer lid and push down until you hear an audible click.

4. Loading cards

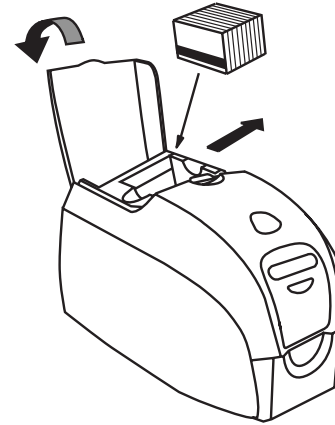

Open card feeder cover. Slide card guide all the way to the right until it locks in place with an audible click.

Remove wrapper from card stack. Place stack of up to 100 cards into the card feeder and close the cover.

When card feeder cover is closed, the card guide locking mechanism will automatically be released.

5. Preparing card output hopper

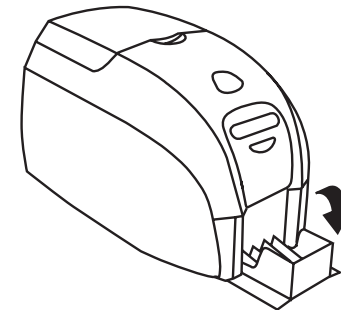

Raise the printer lid and rotate the hopper down.

Return hopper to its closed position when not in use.

Place the printer power switch in the ON (I) position.
- ribbon automatically synchronizes.

6. Starting to print cards

Connect the interface cable, install the Windows driver on your PC and connect your printer when prompted.